

Hardware & Accessories for  
**uPVC & Aluminium Doors,  
Windows & Curtain Walls**

[www.mccoy8m.in](http://www.mccoy8m.in) | 8010-434-434

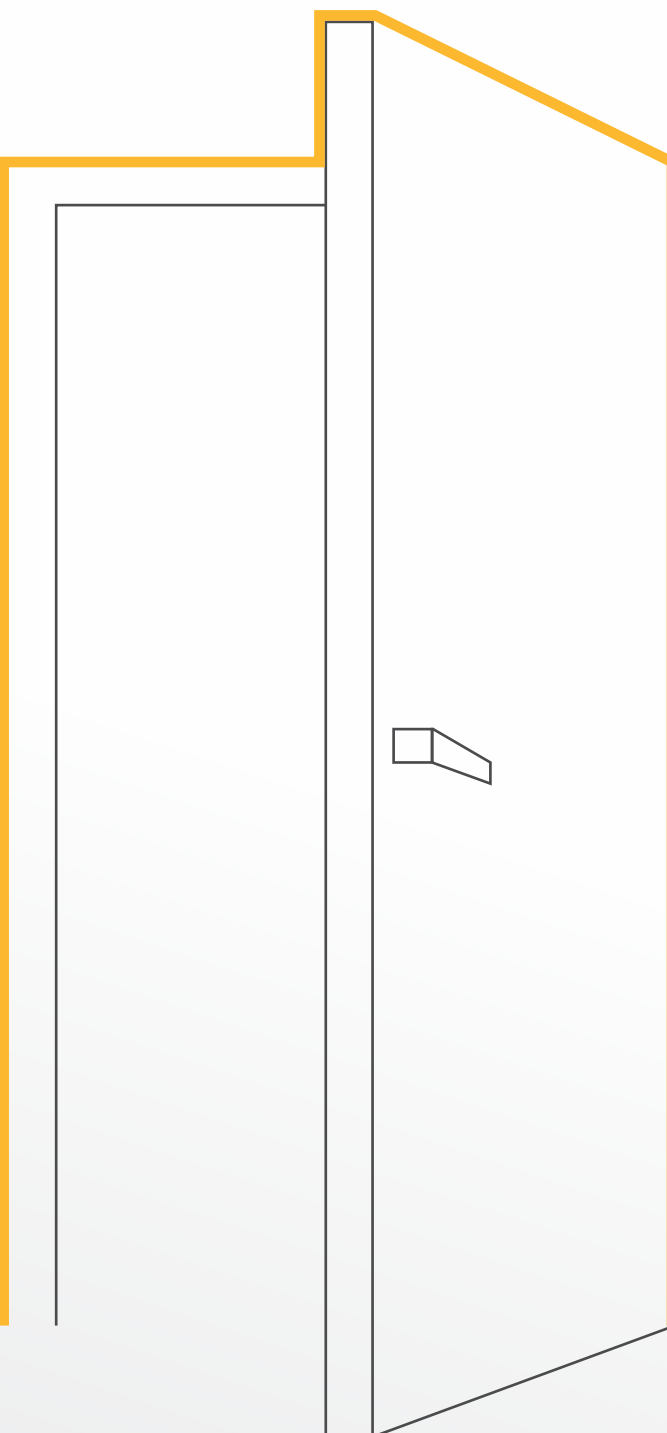

**PVC-U Casement Window Espag - McCoy CEW-S**  
22mm Backset, 400mm-2200mm Length

# PVC-U Casement Window Espag – McCoy CEW-S

22mm Backset, 400mm-2200mm Length

## Highlights:

- Premium Casement Window Espags made from Quality Steel with 3 Coats of Passivation.
- Suitable for Profiles with Euro Grooves.
- Available in Back Set of 22 mm. and Lengths of 400 mm. – 2200 mm.
- Available in Lengths increasing in steps of 200 mm.
- Passivation Coating thickness of 10  $\mu\text{m}$  – 12  $\mu\text{m}$ .
- Unique Cam Adjustment Mechanism for “after closure gap” adjustments of up to  $\pm 0.8$  mm.
- Grade V Corrosion Resistance – Successfully tested for 500 hours of Neutral Salt Spray Test. (Certificate available on request).

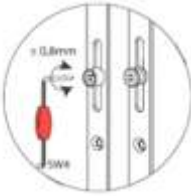

	Feature	Advantage	Benefit
	Cam Adjustment Mechanism to adjust “after closure gap” by $\pm 0.8$ mm.	The play in the Door / Window when the sash is closed can be adjusted by u to 1.6 mm. So, minor gaps between frame and sash resulting in a gap or shaking in the sash, post closure can be adjusted.	Minor manufacturing inaccuracies are taken care of, thereby reducing the Rejection Rates.
	Passivation Coating thickness of 10 $\mu\text{m}$ – 12	Very good resistance to Corrosion.	Can be used in High Humidity or even Corrosive environment.
	Successfully conducted 500 Hours of Neutral Salt Spray Test	Confirms to Grade V Corrosion resistance. Can be used in High Humidity or even Corrosive environment.	Long lasting even in adverse environmental conditions.

Remark: The directives contained in this documentation are the result of our experiments and of our experience and have been submitted in good faith. Because of the diversity of the materials and substrates and the great number of possible applications which are out of our control, we cannot accept any responsibility for the results obtained. In every case it is recommended to carry out preliminary experiments.

## McCoy Silicones Limited

(Facade &amp; Fenestration Division)

C-55, Okhla Industrial Area, Phase-1, New Delhi-110020

Tel: +91-11-40623344 | Fax: +91-11-40623355

info@mccoy8m.in | 8010-434-434  
mccoygroup.in | mccoy8m.in

### Certification



McCoy Soudal is proud to be associated with:



  
A McCoy Group Company

## Technical Data

**Product Code:** McCoy CEW-S

**Specification:** 22mm Backset, 400mm-2200mm Length

**Color:** Available in White Zinc Plating & Chrome +3 Passivation Coating



Product Name	Product Code	Specification	Locking Point & Keeper	Packaging Size (per box)
Casement Espag Backset 22mm	CEW-4S	400mm	2	40
Casement Espag Backset 22mm	CEW-6S	600mm	2	40
Casement Espag Backset 22mm	CEW-8S	800mm	2	40
Casement Espag Backset 22mm	CEW-10S	1000mm	2	40
Casement Espag Backset 22mm	CEW-12S	1200mm	3	40
Casement Espag Backset 22mm	CEW-18S	1800mm	4	20
Casement Espag Backset 22mm	CEW-22S	2200mm	4	20
Keeper	CKW-1			

Remark: The directives contained in this documentation are the result of our experiments and of our experience and have been submitted in good faith. Because of the diversity of the materials and substrates and the great number of possible applications which are out of our control, we cannot accept any responsibility for the results obtained. In every case it is recommended to carry out preliminary experiments.

## McCoy Silicones Limited

(Facade & Fenestration Division)

C-55, Okhla Industrial Area, Phase-1, New Delhi-110020

Tel: +91-11-40623344 | Fax: +91-11-40623355

info@mccoy8m.in | 8010-434-434  
mccoygroup.in | mccoy8m.in

### Certification



McCoy Soudal is proud to be associated with:



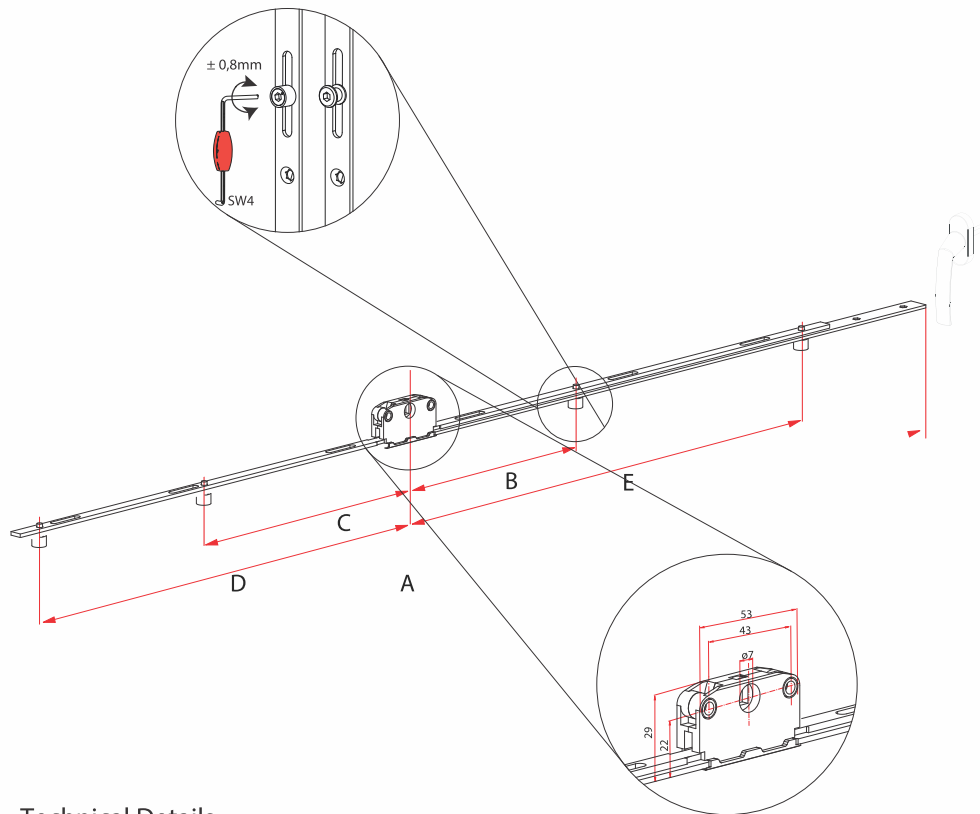

**A McCoy Group Company**

## Specification



## Technical Details

KA	A	B	C	D	E	F		
210-280	210	-	-	-	50.5	-	2	1
280-400	280	-	-	74	74	-	2	2
400-600	400	-	-	135	135	-	3	2
600-800	600	-	-	175	175	-	8	2
800-1000	800	-	-	275	275	-	8	2
1000-1200	1000	94	-	375	375	-	10	3
1200-1400	1200	94	-	475	475	-	10	3
1400-1600	1400	266	266	575	575	-	10	3
1600-1800	1600	300	300	675	675	-	10	3
1800-2000	1800	300	300	775	775	-	12	4
2000-2100	2000	300	300	875	875	-	12	4

Note: Technical detail sizes are millimetric.

Remark: The directives contained in this documentation are the result of our experiments and of our experience and have been submitted in good faith. Because of the diversity of the materials and substrates and the great number of possible applications which are out of our control, we cannot accept any responsibility for the results obtained. In every case it is recommended to carry out preliminary experiments.

## McCoy Silicones Limited

(Facade & Fenestration Division)

C-55, Okhla Industrial Area, Phase-1, New Delhi-110020

Tel: +91-11-40623344 | Fax: +91-11-40623355

info@mccoy8m.in | 8010-434-434  
mccoygroup.in | mccoy8m.in

## Certification



McCoy Soudal is proud to be associated with:



**A McCoy Group Company**

# WELCOME TO THE WORLD OF TECHNOLOGY

## MCCOY PARTNER SELF SERVICE (PSS) APP



- ✓ Quick order
- ✓ Check order status
- ✓ Check account
- ✓ Loyalty rewards
- ✓ Product videos etc..

Download Now



Products available online on  
**mccoymart.com**

www.mccoy8m.in ☎ +91-8010434434

Remark: The directives contained in this documentation are the result of our experiments and of our experience and have been submitted in good faith. Because of the diversity of the materials and substrates and the great number of possible applications which are out of our control, we cannot accept any responsibility for the results obtained. In every case it is recommended to carry out preliminary experiments.

### McCoy Silicones Limited

(Facade & Fenestration Division)

C-55, Okhla Industrial Area, Phase-1, New Delhi-110020

Tel: +91-11-40623344 | Fax: +91-11-40623355

info@mccoy8m.in | 8010-434-434  
mccoygroup.in | mccoy8m.in

#### Certification



McCoy Soudal is proud to be associated with:



**A McCoy Group Company**